

# EUROPLAST IMF

## Assembly instruction

For products: IMF19-SD100-1  
IMF19-SD125-1  
IMF19-SD160-1  
IMF19-SD200-1



www.europlast.lv

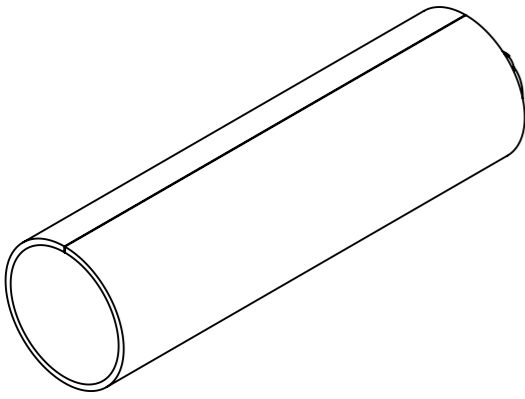

1

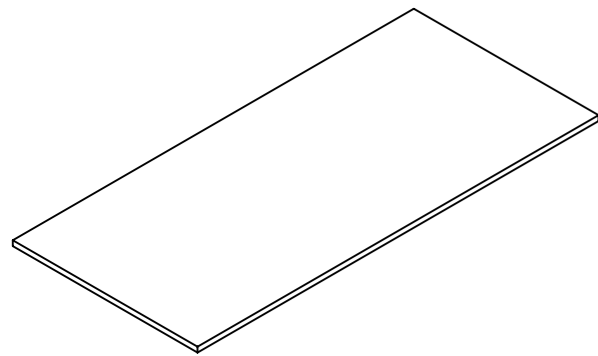

2.1

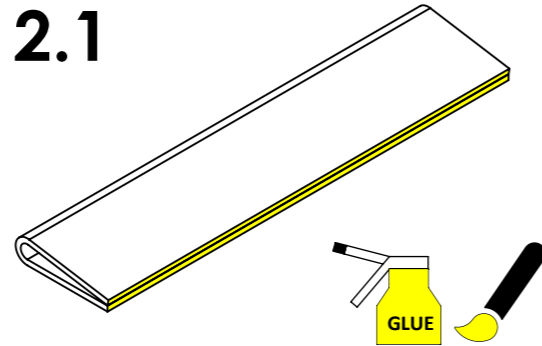

2.2

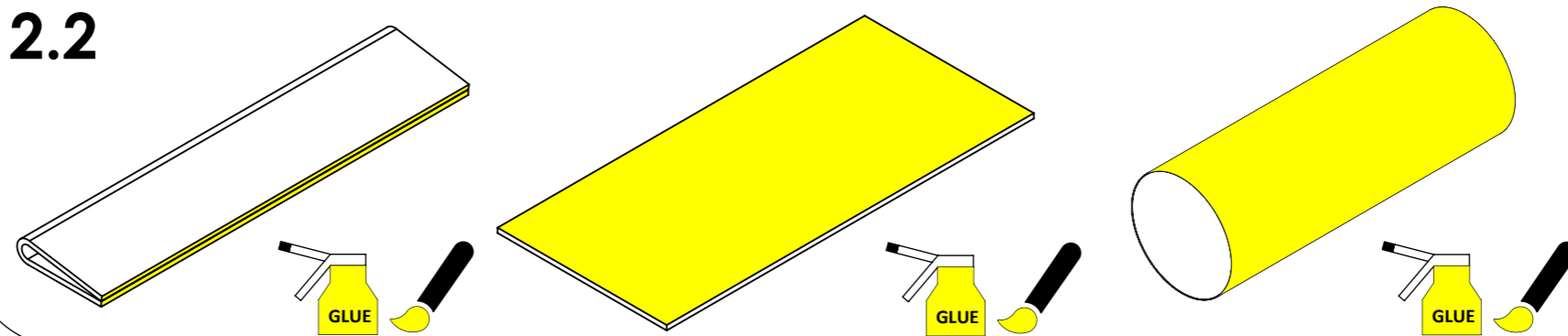

3

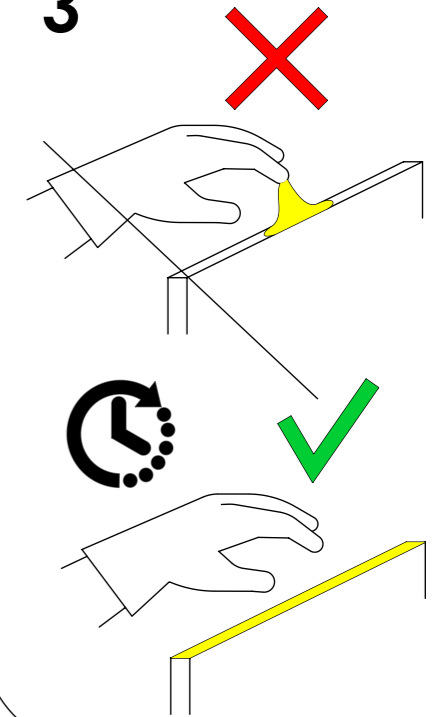

4

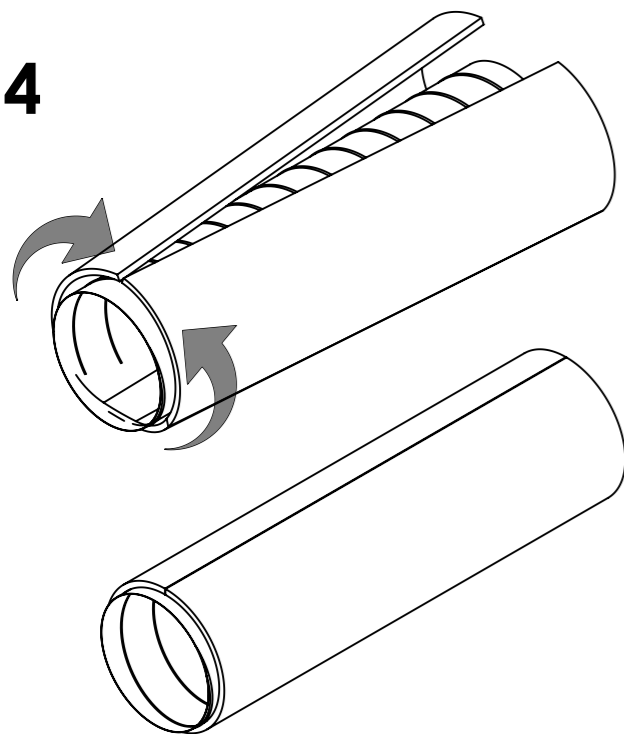

5\* **Rekommendation**

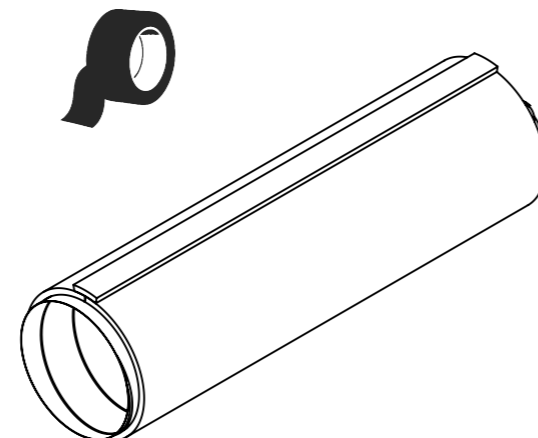

6

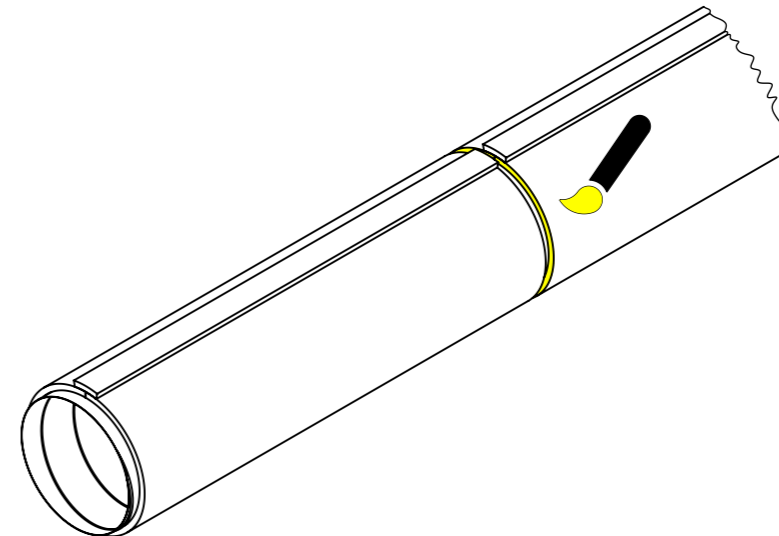

www.europlast.lv



"EIROPLASTS" SIA

32/6 Granita Street, Acone  
Salaspils municipality,  
LV-2119, Latvia

Tel.: +371 67 387 366,  
Mob.tel.: +371 28 664 918  
E-mail: europlast@europlast.lv  
www.europlast.lv

Doc. Title:  
Europlast\_IMF19\_Instruction\_EN.pdf  
Date.: 29.06.2026 | PIRK2, PS1

Installation instructions for insulation material  
Products: IMF19-SD-100-1, IMF19-SD-125-1, IMF19-SD-160-1, IMF19-SD-200-1

Notes, Please observe:

- Read, understand, and follow the instructions described in this document, as well as all other applicable local regulations, company policies, national requirements, and guidelines regarding the storage, use, and disposal of materials.
- Installation work shall be carried out by trained and experienced insulation and installation specialists, or under their supervision.
- Appropriate personal protective equipment (PPE) must always be worn, including safety glasses, protective gloves, a respirator, protective clothing, and other required safety equipment.
- Use only an adhesive specifically intended for bonding Flexible Elastomeric Foam (FEF) (synthetic rubber) insulation materials.

- 1 Place the insulation material for a circular air duct on a clean, flat surface that is easily accessible and protected from possible adhesive contamination.
- 2.1 Application primarily for thermal and acoustic insulation
  - 1) Apply adhesive to the surfaces of the longitudinal edges of the insulation material.
- 2.2 Application primarily for condensation (cooling) insulation
  - 1) Apply adhesive to the surfaces of the longitudinal edges of the insulation material.
  - 2) Apply adhesive to one of the larger flat surfaces of the insulation material.
  - 3) Apply adhesive to the outer surface of the air duct.
- 3 Allow the adhesive to dry until it becomes tacky and is no longer liquid or stringy.
- 4 Position the center of the insulation piece on the centerline of the air duct, with the longitudinal edge of the insulation material aligned parallel to the axis of the duct. Gradually wrap the insulation evenly around the air duct, keeping both edges aligned until they meet on the opposite side. Join the insulation edges by carefully pressing them together to form a neat longitudinal seam running along the length of the air duct.
- 5\* Recommendation - For additional protection, the bonded seam may be covered with insulation tape made from the same material (Product: IF-LI50-15).
- 6 Bond the edges of the insulation material together where they meet on the air duct and adjoining duct fittings.

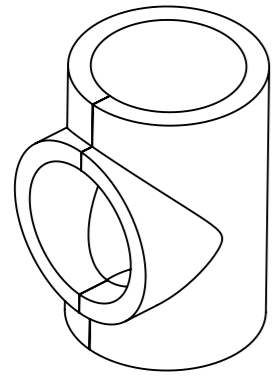

# EUROPLAST IMF

## Assembly instruction

For products: IMF19-TCPS-100-100  
IMF19-TCPS-120-100  
IMF19-TCPS-160-100  
IMF19-TCPS-200-125



www.europplast.lv



1

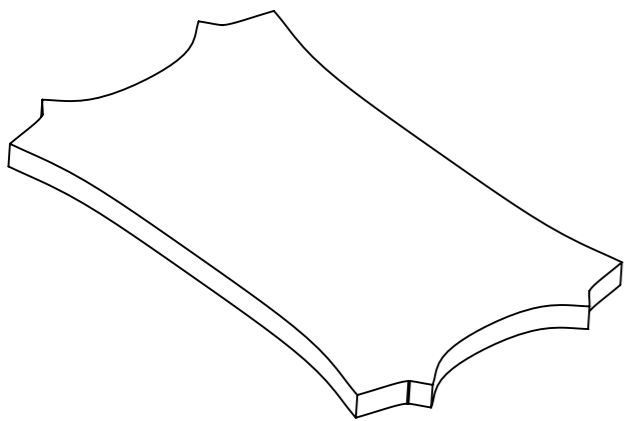

2.1

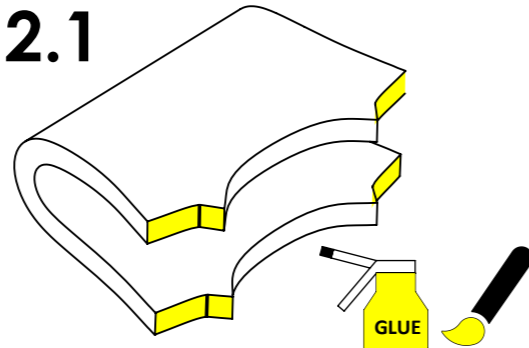

2.2

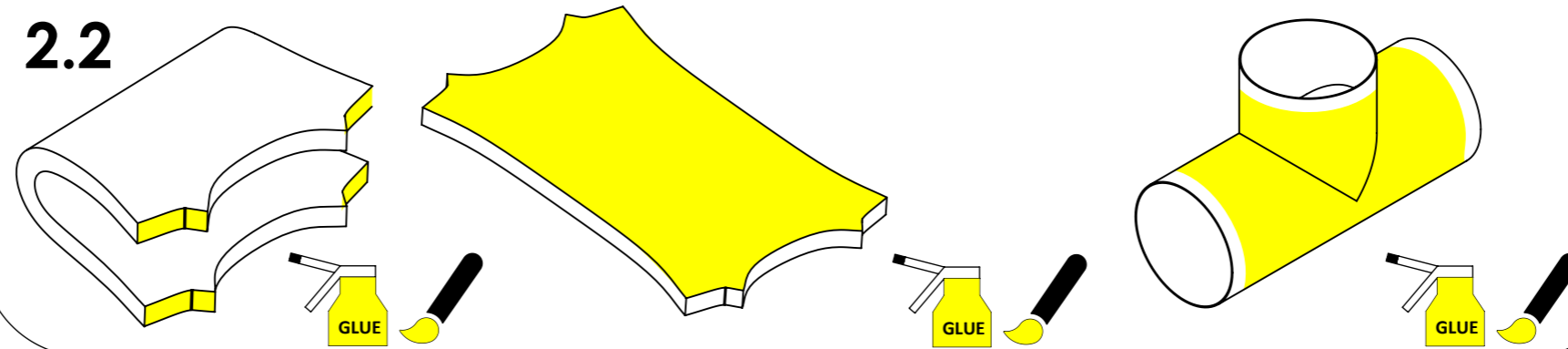

3

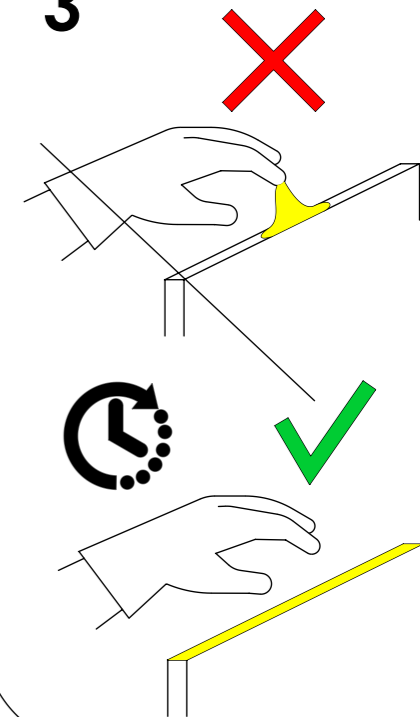

4

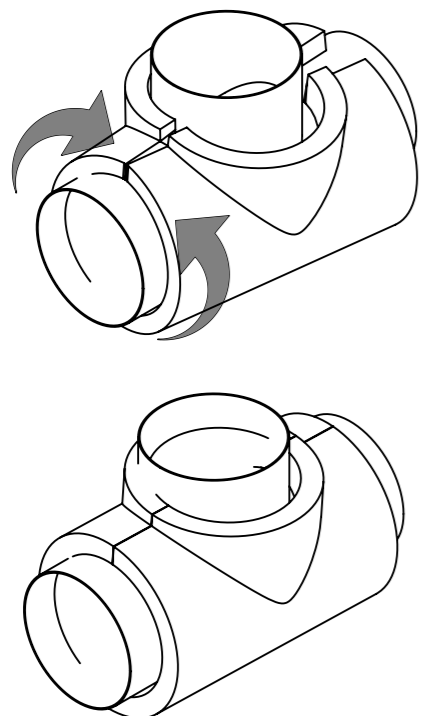

5\* **Rekommendation**

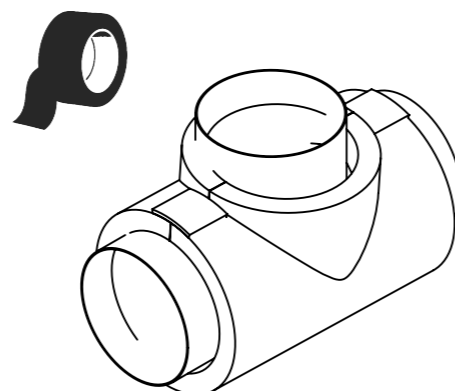

6

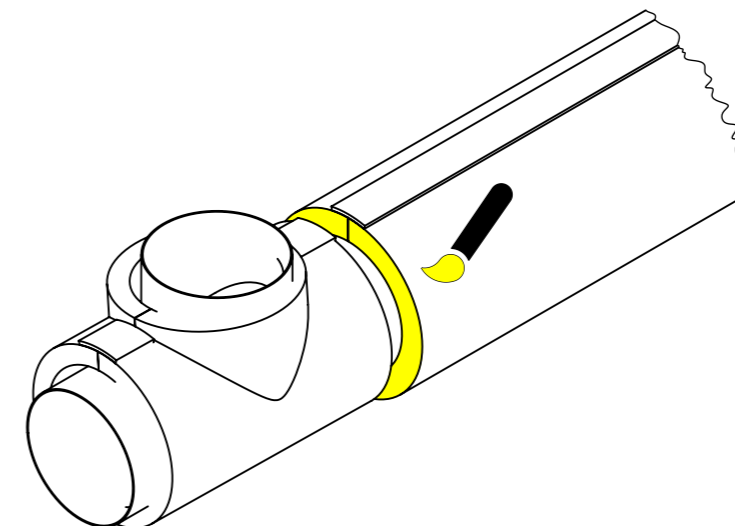

www.europplast.lv



"EIROPLASTS" SIA

32/6 Granita Street, Acone  
Salaspils municipality,  
LV-2119, Latvia

Tel.: +371 67 387 366,  
Mob.tel.: +371 28 664 918  
E-mail: europplast@europplast.lv  
www.europplast.lv

Doc. Title:  
Europlast\_IMF19\_Instruction\_EN.pdf  
Date.: 29.06.2026 | PIRK2, PS1

## Installation instructions for insulation material

Products: IMF19-TCPS-100-100, IMF19-TCPS-125-100, IMF19-TCPS-160-100, IMF19-TCPS-200-125

### Notes, Please Observe:

- Read, understand, and follow the instructions described in this document, as well as all other applicable local regulations, company policies, national requirements, and guidelines regarding the storage, use, and disposal of materials.
- Installation work shall be carried out by trained and experienced insulation and installation specialists, or under their supervision.
- Appropriate personal protective equipment (PPE) must always be worn, including safety glasses, protective gloves, a respirator, protective clothing, and other required safety equipment.
- Use only an adhesive specifically intended for bonding Flexible Elastomeric Foam (FEF) (synthetic rubber) insulation materials.

- 1 Place the insulation material for a circular T-joint on a clean, flat surface that is easily accessible and protected from possible adhesive contamination.
- 2.1 Application primarily for thermal and acoustic insulation
  - 1) Apply adhesive to the surfaces of the shorter edges of the insulation material.
- 2.2 Application primarily for condensation (cooling) insulation
  - 1) Apply adhesive to the surfaces of the shorter edges of the insulation material.
  - 2) Apply adhesive to one of the larger flat surfaces of the insulation material.
  - 3) Apply adhesive to the outer surface of the T-joint. .
- 3 Allow the adhesive to dry until it becomes tacky and is no longer liquid or stringy.
- 4 Position the center of the insulation piece on the centerline of the main section of the T-joint (the side without the branch connection). Gradually wrap the insulation around the T-joint, keeping both edges aligned evenly while moving toward the side with the branch connection. Join the insulation edges by carefully pressing them together to form a neat seam around the branch connection of the T-joint.
- 5\* Recommendation - for additional protection, the bonded seam may be covered with insulation tape made from the same material (Product: IF-LI50-15).
- 6 Bond the edges of the insulation material together where they meet on the air duct and the duct fitting.

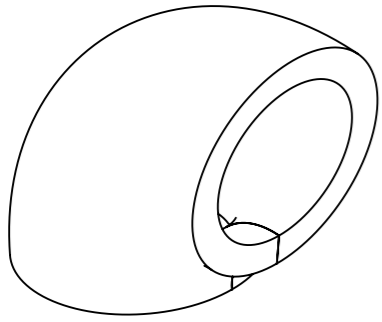

# EUROPLAST IMF

## Assembly instruction

For products: IMF19-BFS90-100  
IMF19-BFS90-125  
IMF19-BFS90-160  
IMF19-BFS90-200



www.europlast.lv



1

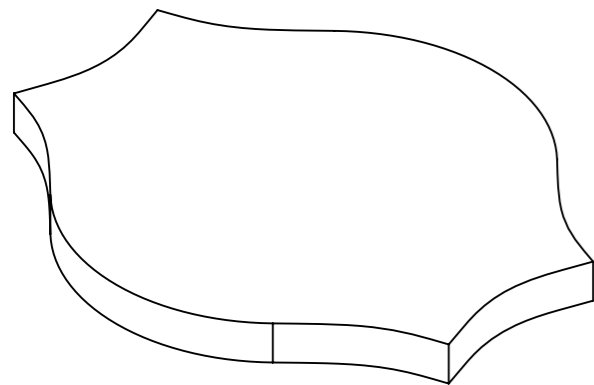

2.1

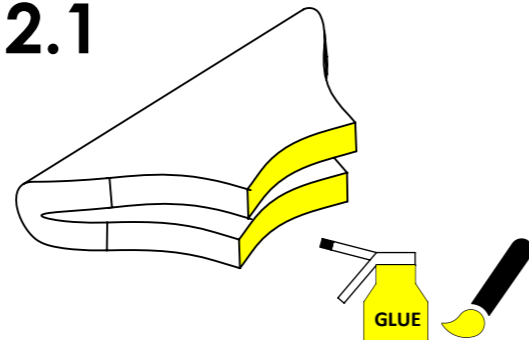

2.2

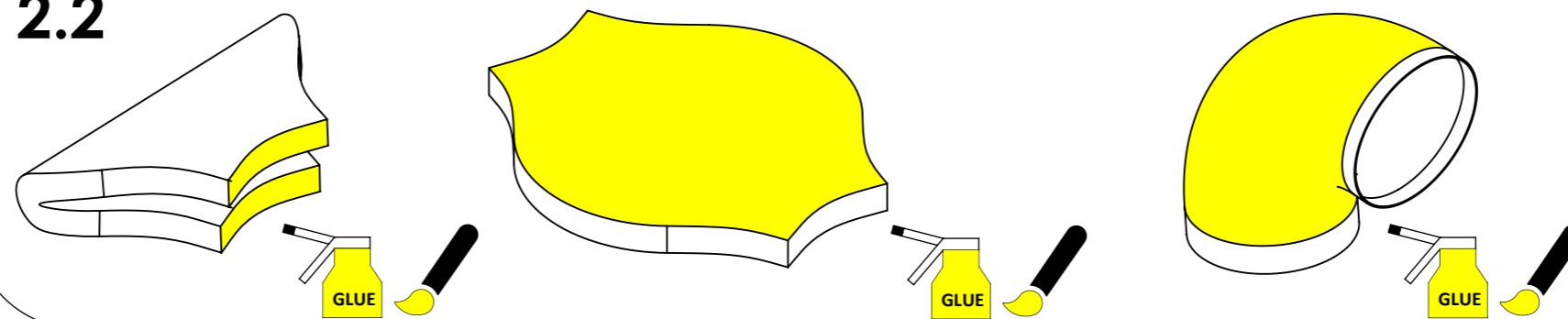

3

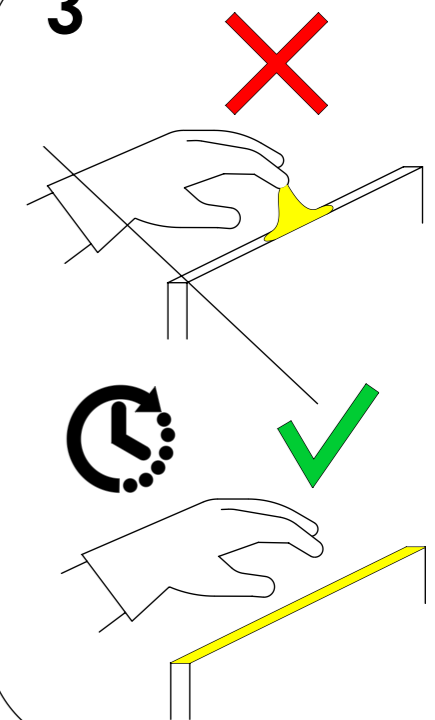

4

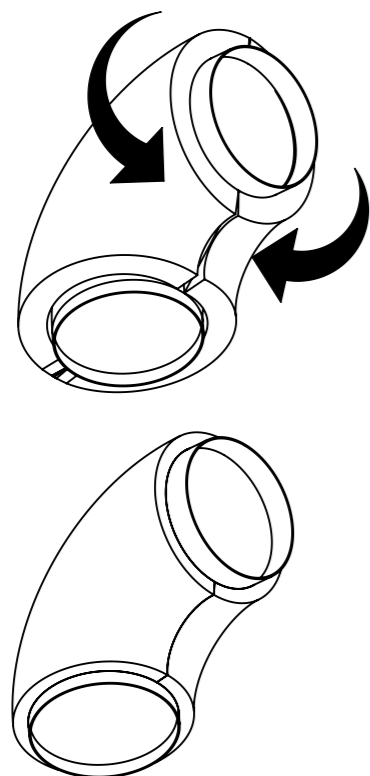

5\* **Rekommendation**

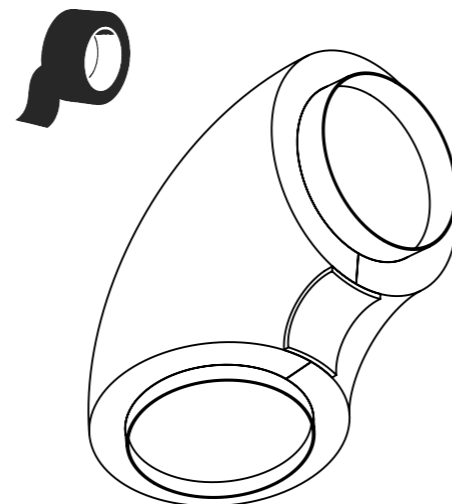

6

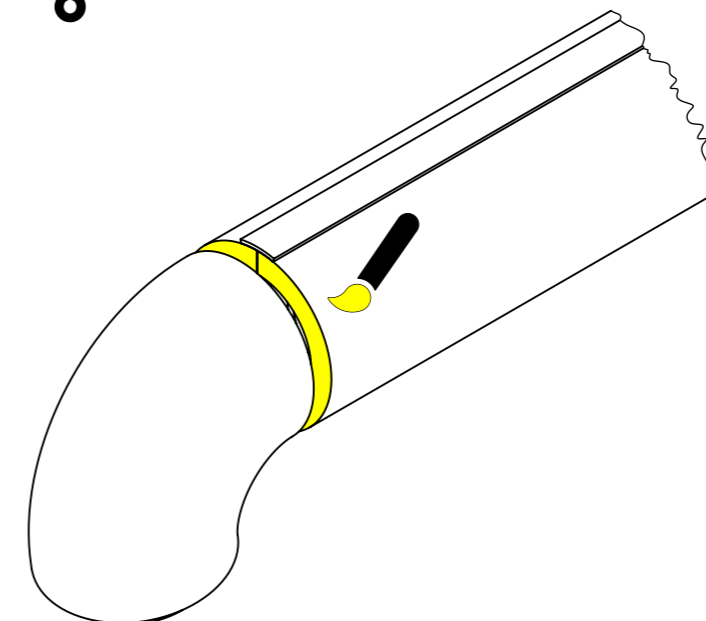

www.europlast.lv



"EIROPLASTS" SIA

32/6 Granita Street, Acone  
Salaspils municipality,  
LV-2119, Latvia

Tel.: +371 67 387 366,  
Mob.tel.: +371 28 664 918  
E-mail: europlast@europlast.lv  
www.europlast.lv

Doc. Title:  
Europlast\_IMF19\_Instruction\_EN.pdf  
Date.: 29.06.2026 | PIRK2, PS1

Installation instructions for insulation material  
Products: IMF19-BFS90-100, IMF19-BFS90-125, IMF19-BFS90-160, IMF19-BFS90-200

Notes, Please observe:

- Read, understand, and follow the instructions described in this document, as well as all other applicable local regulations, company policies, national requirements, and guidelines regarding the storage, use, and disposal of materials.
- Installation work shall be carried out by trained and experienced insulation and installation specialists, or under their supervision.
- Appropriate personal protective equipment (PPE) must always be worn, including safety glasses, protective gloves, a respirator, protective clothing, and other required safety equipment.
- Use only an adhesive specifically intended for bonding Flexible Elastomeric Foam (FEF) (synthetic rubber) insulation materials.

1 Place the insulation material for a 90° elbow with a circular cross-section of Ø100 mm, Ø125 mm, Ø160 mm, or Ø200 mm on a clean, flat surface that is easily accessible and protected from possible adhesive contamination.

2.1 Application primarily for thermal and acoustic insulation

1) Apply adhesive to the surfaces of the shorter edges of the insulation material.

2.2 Application primarily for condensation (cooling) insulation

1) Apply adhesive to the surfaces of the shorter edges of the insulation material.

2) Apply adhesive to one of the larger flat surfaces of the insulation material.

3) Apply adhesive to the outer surface of the elbow.

3 Allow the adhesive to dry until it becomes tacky and is no longer liquid or stringy.

4 Position the center of the insulation piece at the center of the outer (larger radius) side of the elbow. Gradually wrap the insulation around the fitting, aligning both edges evenly while moving toward the inner (smaller radius) side of the elbow. Join the insulation edges by carefully pressing them together to form a neat seam located along the centerline of the inner (smaller radius) side of the elbow.

5\* Recommendation - For additional protection, the bonded seam may be covered with insulation tape made from the same material (Product: IF-LI50-15).

6 Bond the edges of the insulation material together where they meet on the air duct and the duct fitting.

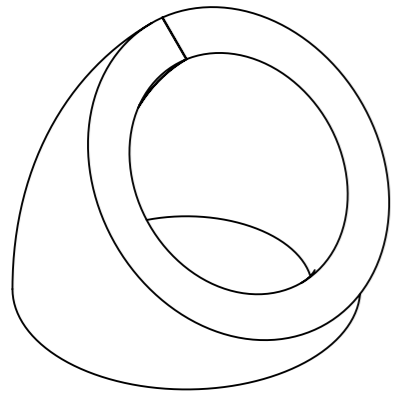

# EUROPLAST IMF

## Assembly instruction

For products: IMF19-BFS45-100  
IMF19-BFS45-125



www.europlast.lv



1

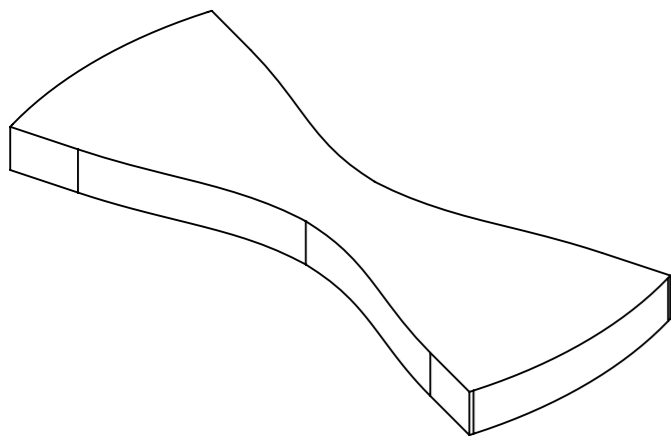

2.1

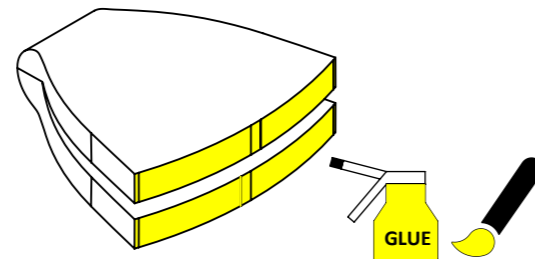

2.2

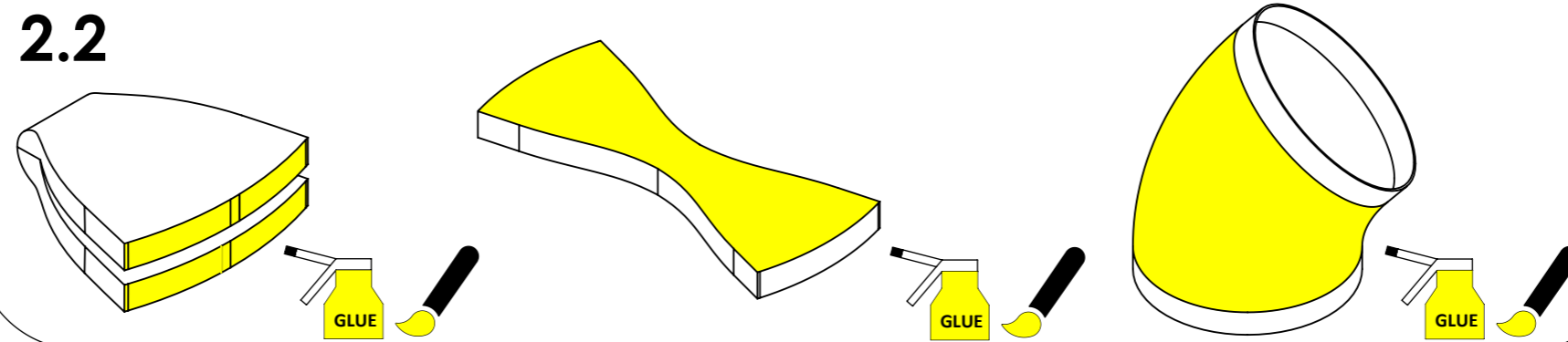

3

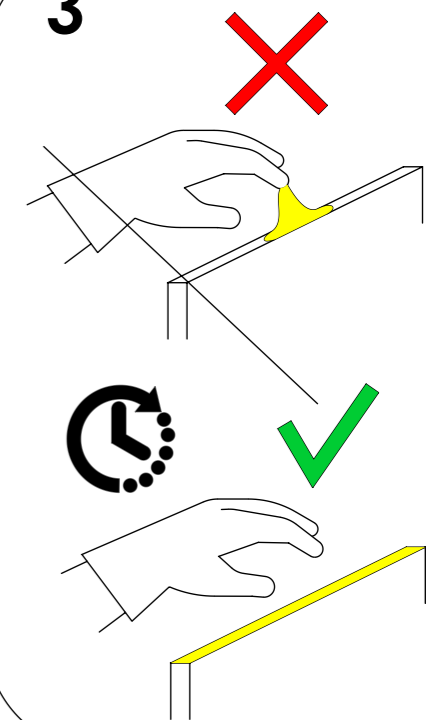

4

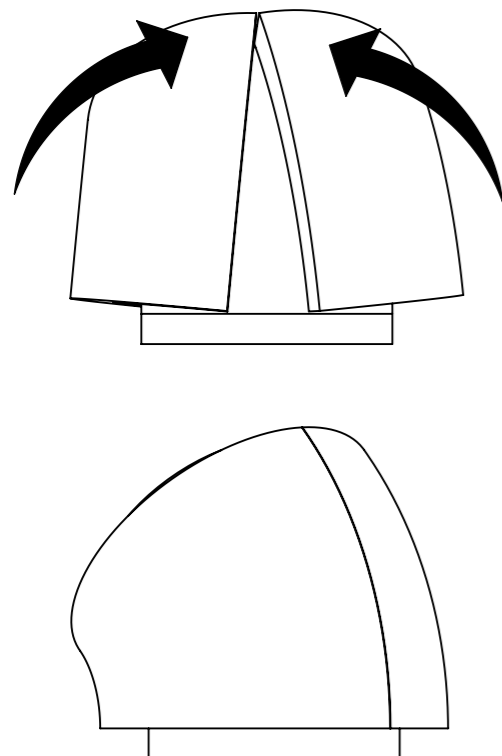

5\* **Rekommendation**

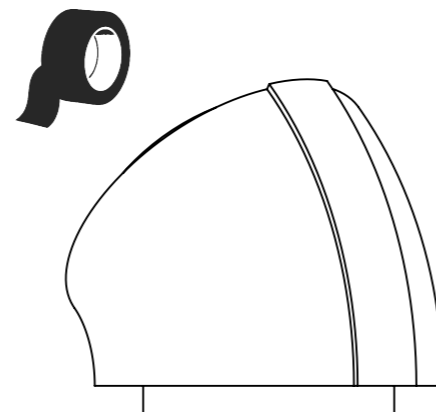

6

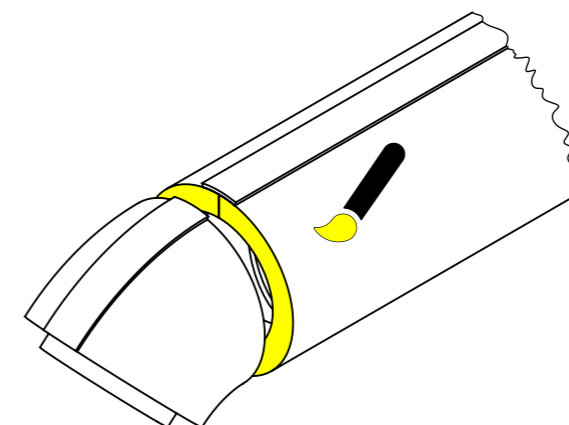

www.europlast.lv



"EIROPLASTS" SIA

32/6 Granita Street, Acone  
Salaspils municipality,  
LV-2119, Latvia

Tel.: +371 67 387 366,  
Mob.tel.: +371 28 664 918  
E-mail: europlast@europlast.lv  
www.europlast.lv

Doc. Title:  
Europlast\_IMF19\_Instruction\_EN.pdf  
Date.: 29.06.2026 | PIRK2, PS1

Installation instructions for insulation material  
Products: IMF19-BFS45-160, IMF19-BFS45-200

Notes, Please observe:

- Read, understand, and follow the instructions described in this document, as well as all other applicable local regulations, company policies, national requirements, and guidelines regarding the storage, use, and disposal of materials.
- Installation work shall be carried out by trained and experienced insulation and installation specialists, or under their supervision.
- Appropriate personal protective equipment (PPE) must always be worn, including safety glasses, protective gloves, a respirator, protective clothing, and other required safety equipment.
- Use only an adhesive specifically intended for bonding Flexible Elastomeric Foam (FEF) (synthetic rubber) insulation materials.

- 1 Place the insulation material for a 45° elbow with a circular cross-section of  $\varnothing 160$  mm or  $\varnothing 200$  mm on a clean, flat surface that is easily accessible and protected from possible adhesive contamination.
  - 2.1 Application primarily for thermal and acoustic insulation
    - 1) Apply adhesive to the surfaces of the shorter edges of the insulation material.
  - 2.2 Application primarily for condensation (cooling) insulation
    - 1) Apply adhesive to the surfaces of the shorter edges of the insulation material.
    - 2) Apply adhesive to one of the larger flat surfaces of the insulation material.
    - 3) Apply adhesive to the outer surface of the elbow.
- 3 Allow the adhesive to dry until it becomes tacky and is no longer liquid or stringy.
- 4 Position the center of the insulation piece at the center of the outer (larger radius) side of the elbow. Gradually wrap the insulation around the fitting, aligning both edges evenly while moving toward the inner (smaller radius) side of the elbow. Join the insulation edges by carefully pressing them together to form a neat seam located along the centerline of the inner (smaller radius) side of the elbow.
- 5\* Recommendation - for additional protection, the bonded seam may be covered with insulation tape made from the same material (Product: IF-LI50-15).
- 6 Bond the edges of the insulation material together where they meet on the air duct and the duct fitting.

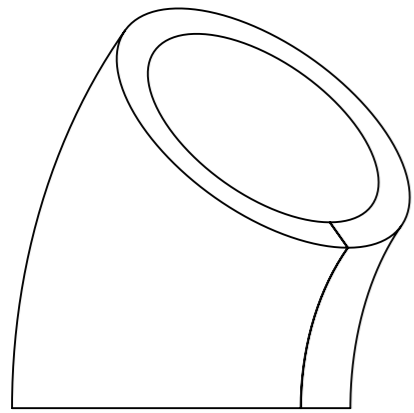

# EUROPLAST IMF

## Assembly instruction

For products: IMF19-BFS45-160  
IMF19-BFS45-200



www.europlast.lv



1

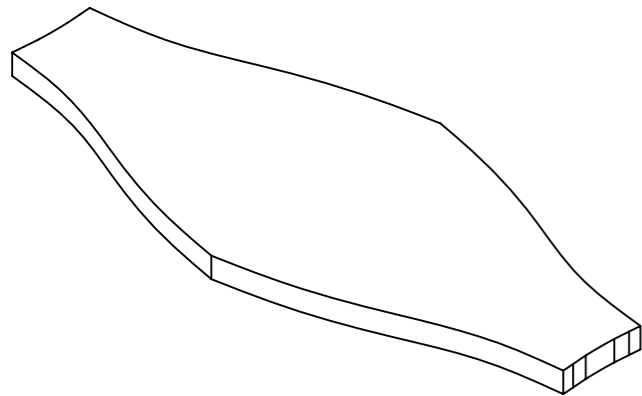

2.1

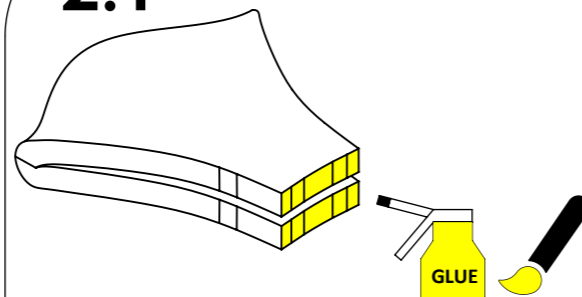

2.2

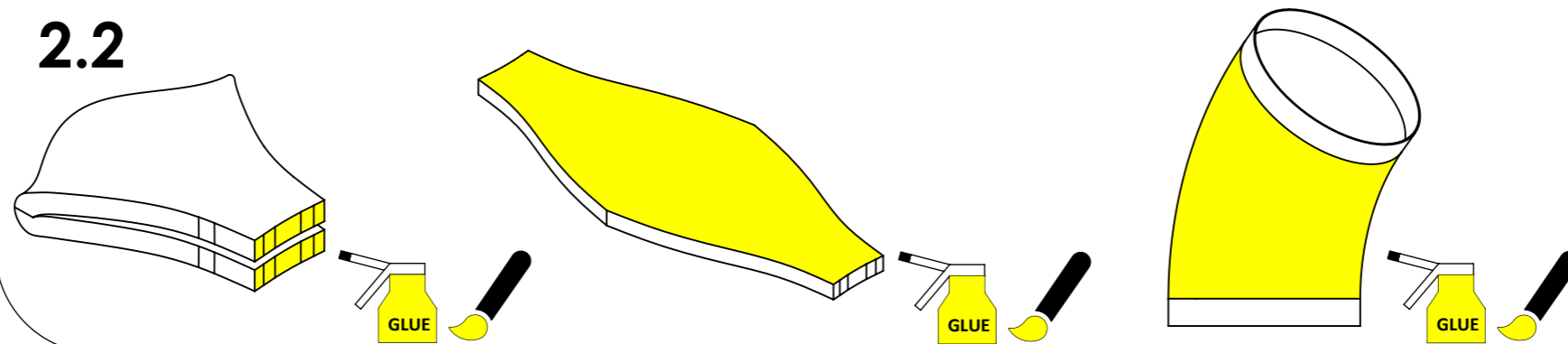

3

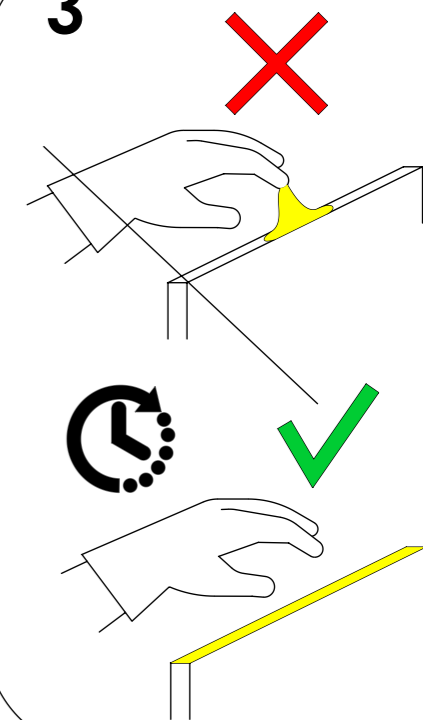

4

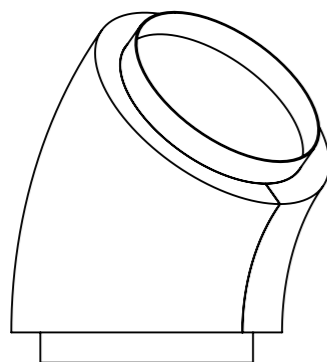
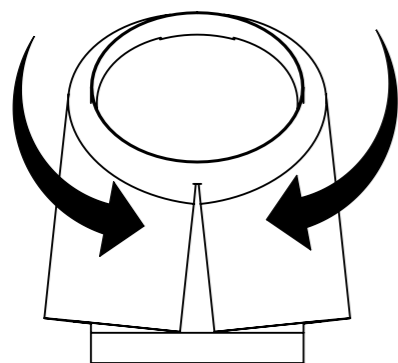

5\* Rekomendation

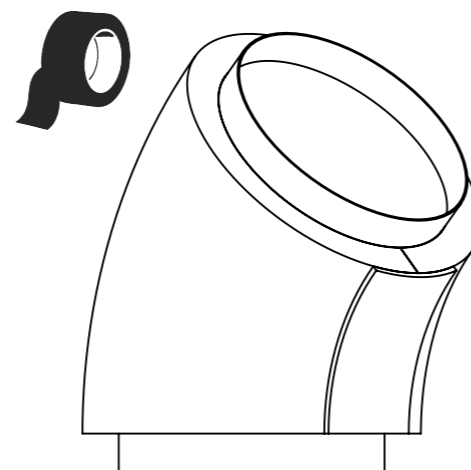

6

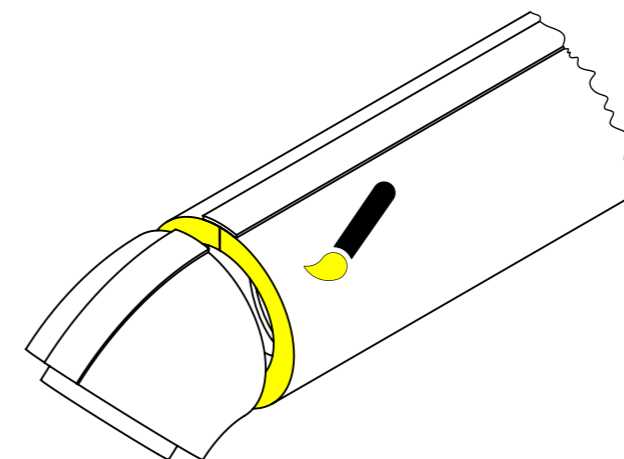

www.europlast.lv



"EIROPLASTS" SIA

32/6 Granita Street, Acone  
Salaspils municipality,  
LV-2119, Latvia

Tel.: +371 67 387 366,  
Mob.tel.: +371 28 664 918  
E-mail: europlast@europlast.lv  
www.europlast.lv

Doc. Title:  
Europlast\_IMF19\_Instruction\_EN.pdf  
Date.: 29.06.2026 | PIRK2, PS1

Installation instructions for insulation material  
Products: IMF19-BFS45-100, IMF19-BFS45-125

Notes, Please observe:

- Read, understand, and follow the instructions described in this document, as well as all other applicable local regulations, company policies, national requirements, and guidelines regarding the storage, use, and disposal of materials.
- Installation work shall be carried out by trained and experienced insulation and installation specialists, or under their supervision.
- Appropriate personal protective equipment (PPE) must always be worn, including safety glasses, protective gloves, a respirator, protective clothing, and other required safety equipment.
- Use only an adhesive specifically intended for bonding Flexible Elastomeric Foam (FEF) (synthetic rubber) insulation materials.

1 Place the insulation material for a 45° elbow with a circular cross-section of Ø100 mm or Ø125 mm on a clean, flat surface that is easily accessible and protected from possible adhesive contamination.

2.1 Application primarily for thermal and acoustic insulation

1) Apply adhesive to the surfaces of the shorter edges of the insulation material.

2.2 Application primarily for condensation (cooling) insulation

1) Apply adhesive to the surfaces of the shorter edges of the insulation material.

2) Apply adhesive to one of the larger flat surfaces of the insulation material.

3) Apply adhesive to the outer surface of the elbow.

3 Allow the adhesive to dry until it becomes tacky and is no longer liquid or stringy.

4 Position the center of the insulation piece at the center of the inner (smaller radius) side of the elbow.

Gradually wrap the insulation around the fitting, aligning both edges evenly while moving toward the outer (larger radius) side of the elbow.

Join the insulation edges by carefully pressing them together to form a neat seam located along the centerline of the outer (larger radius) side of the elbow.

5\* Recommendation - for additional protection, the bonded seam may be covered with insulation tape made from the same material (Product: IF-LI50-15).

6 Bond the edges of the insulation material together where they meet on the air duct and the duct fitting.